

SOCKET CONNECTOR, THT

PITCH - VARIABLE

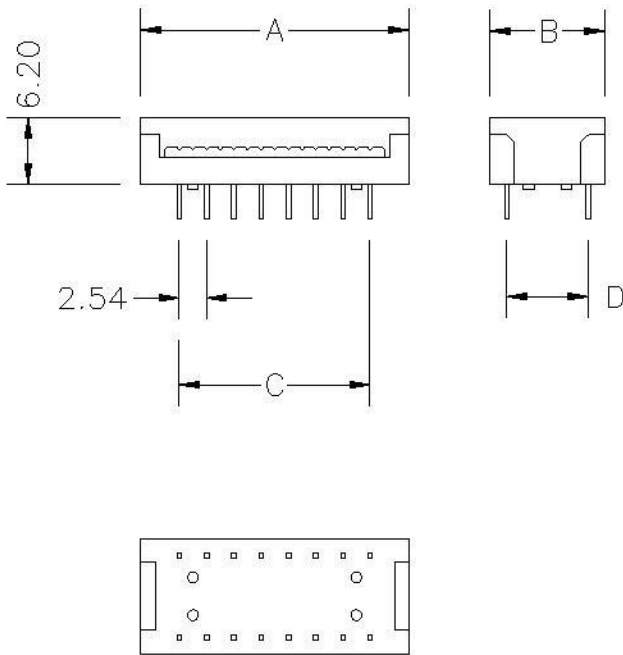

No. of Contacts	A	B	C	D
8	14.82	10.70	7.62	7.62
14	22.44	10.70	15.24	7.62
16	24.98	10.70	17.78	7.62
24	35.14	18.30	27.94	15.24
40	55.46	18.30	48.26	15.24

Specifications

Material

Contacts: Phosphor Bronze
 Insulator: PBT, glass reinforced, UL94V-0

Electrical

Current Rating: 1.0A
 Contact Resistance: 20mOhm max.
 Insulation Resistance: 5000MOhm min.
 Withstanding Voltage: 1000V AC for 1 minute
 Operating Temperature: -40°C to + 105°C

SPSCxx-4000

Not used 0 (Standard)
 Not used 0 (Standard)
 Pin length: 0 = 4.2mm (Standard)
 1 = 3.2mm
 Requirement level: 4 = RL4 = tin plated, 50 mating cycles
 No. of contacts

